

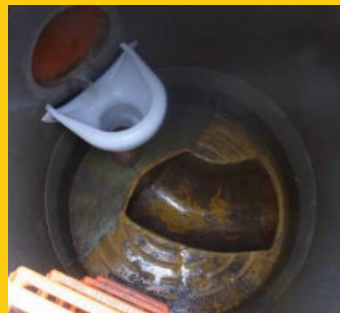

DROP STRUCTURES

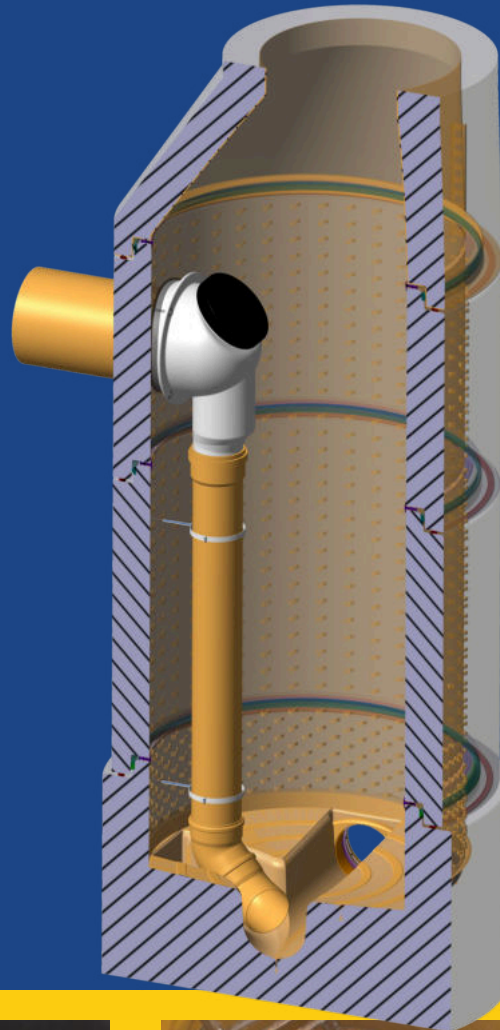

Inside Drop Type 1

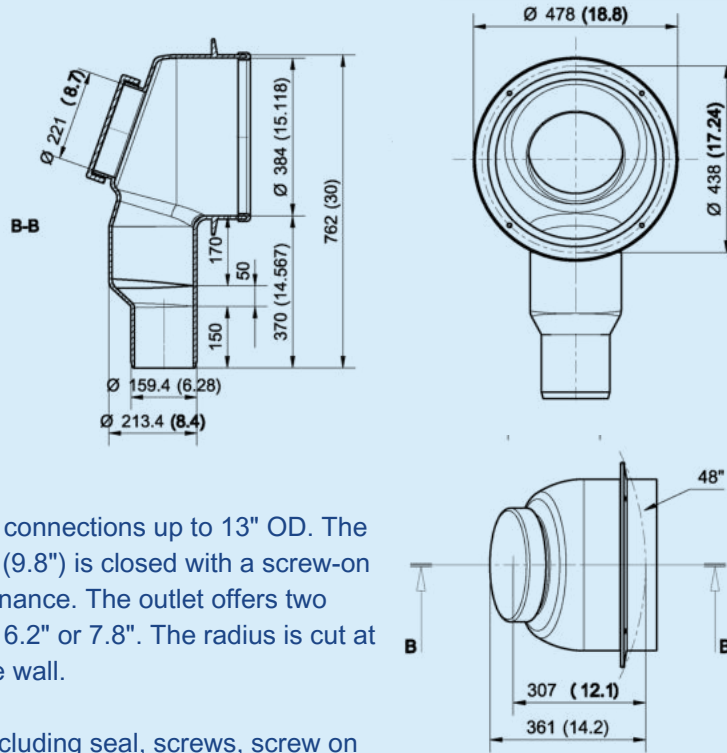

The Inside Drop Type 1 enables connections up to 13" OD. The maintenance/ inspection access (9.8") is closed with a screw-on cover; angled for ease of maintenance. The outlet offers two different diameters, either of OD 6.2" or 7.8". The radius is cut at the factory to match the manhole wall.

Included in delivery: backdrop including seal, screws, screw on cover, stainless steel cable and wall plugs.

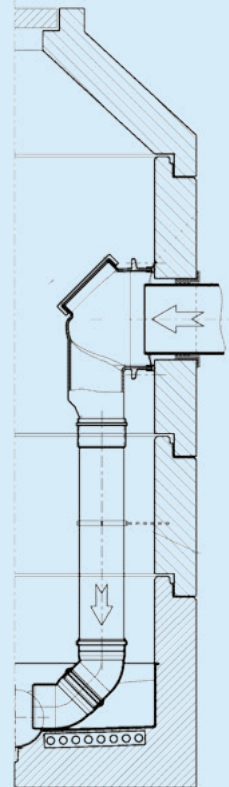

IPK for Inside Backdrop

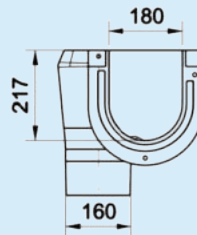
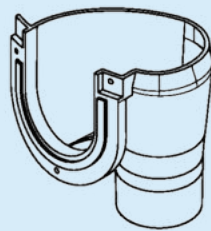
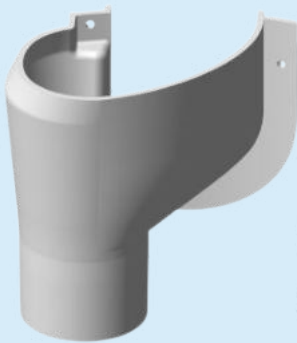

manhole DN1000/1200

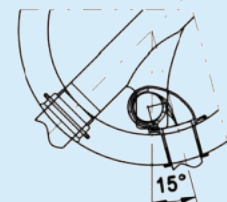

IPK 150 - right
inlet right from the drop pipe

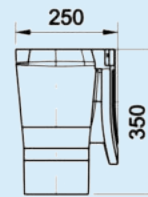

manhole DN1000/1200

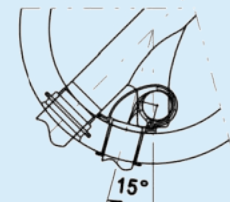

IPK 150 - left
inlet left from the drop pipe

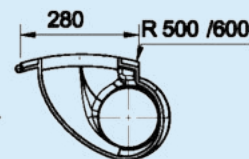

The IPK enables pipe connections up to 7" OD. Its special construction causes a cyclone-like stream which reduces the flow of energy of the sewage. The outlet has a nominal diameter of 6.2".

Included in delivery: backdrop including seal, screws and wall plugs.

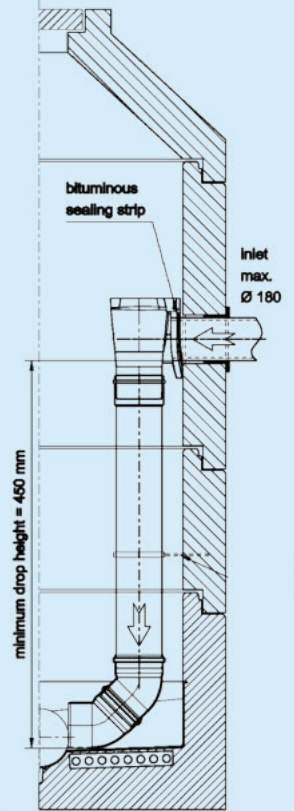

Inside Funnel 500

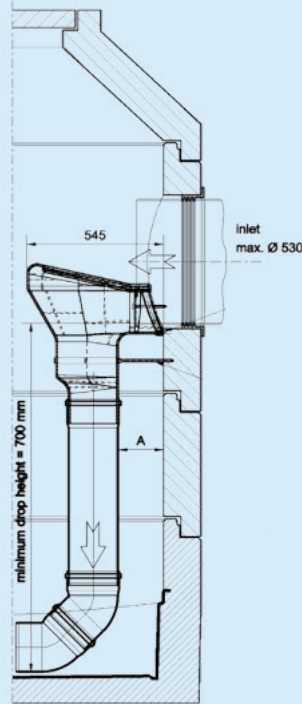
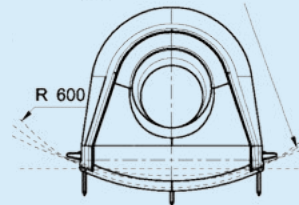
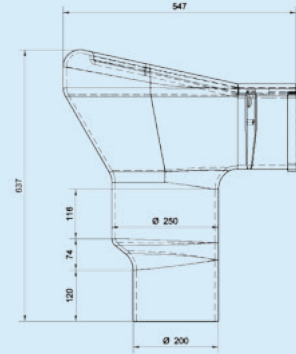
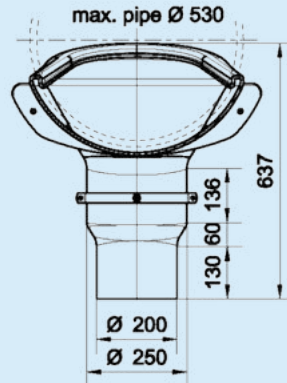

The Inside Funnel 500 enables connections up to 20" OD. The outlet offers two different diameters, either of 7.8" or 9.8" OD. The radius is cut at the factory to match the manhole wall.

Included in delivery: backdrop including seal, screws and wall plugs Stainless steel pipe clamp DIN 250.

Radius-cut according to customer's request Min. 600, Max. 1600 to straight wall

Inside Funnel 200

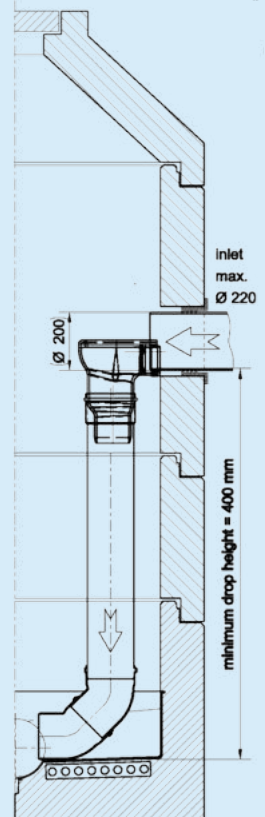
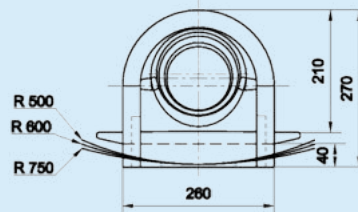
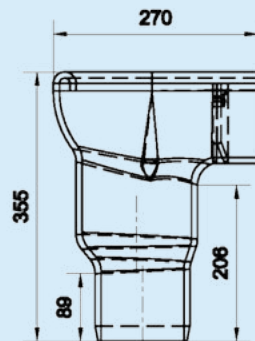
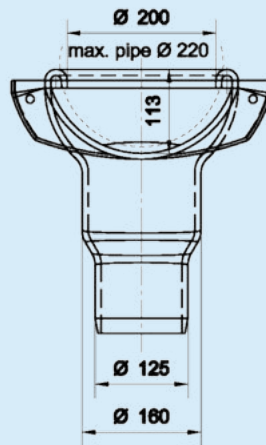

The Inside Funnel 200 enables connections up to 8.6" OD. The outlet offers two different diameters, either of 4.9" or 6.7" OD, the radius is cut at the factory to match the manhole wall.

Included in delivery: backdrop including seal, screws and wall plugs.

Radius-cut according to customer's request R Min. 500 up, to straight wall

GU Inside Drop

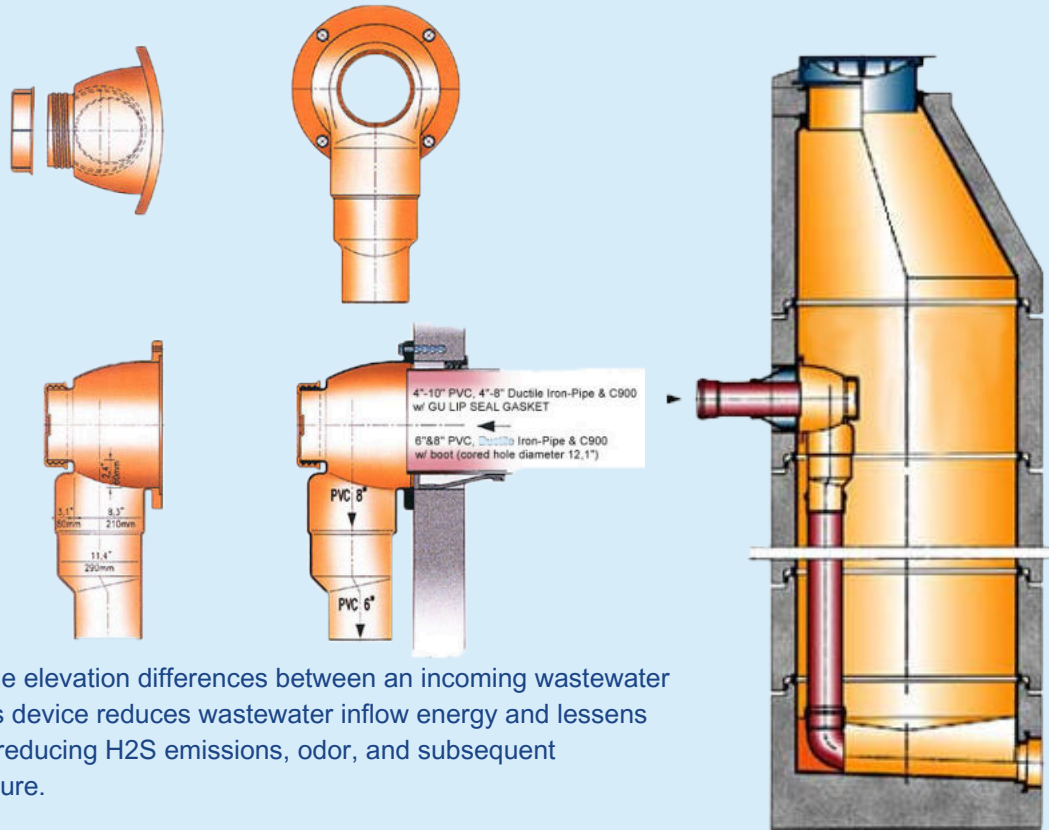

The GU Inside Drop serves to overcome elevation differences between an incoming wastewater connection and the manhole base. This device reduces wastewater inflow energy and lessens turbulent entry into main channel flow, reducing H₂S emissions, odor, and subsequent erosion/corrosion of the manhole structure.

Included in delivery: inside drop, cap, and seal.

